



| AQUATIC PLANNING, DESIGN & ENGINEERING

YOUR
WORLD
IN WATER.

INTRODUCTION

Water Technology, Inc. (WTI) and **Neuman Group** combine independent aquatic planning, design, engineering, and construction expertise to deliver complex aquatic destinations with clarity and accountability.

WTI is an independent, licensed aquatic planning, design, and engineering firm specializing in custom water attractions, waterparks, and leisure environments. Serving as an owner's advocate, WTI provides objective guidance, creative problem solving, and disciplined engineering focused on long term performance and operational success.

Neuman Group is a design-build partner specializing in the construction and delivery of large scale destination aquatic projects. With in house construction managers and specialist builders, Neuman Group delivers an integrated approach to cost, schedule, procurement, construction, and commissioning.

Together, WTI and Neuman Group operate as a unified team – aligning vision, design, engineering, and construction from the outset to reduce risk, improve efficiency, and deliver high quality aquatic environments built to perform from day one.



GLOBAL DELIVERY

Office / Project Leadership Locations
North America, Europe, Middle East, Asia

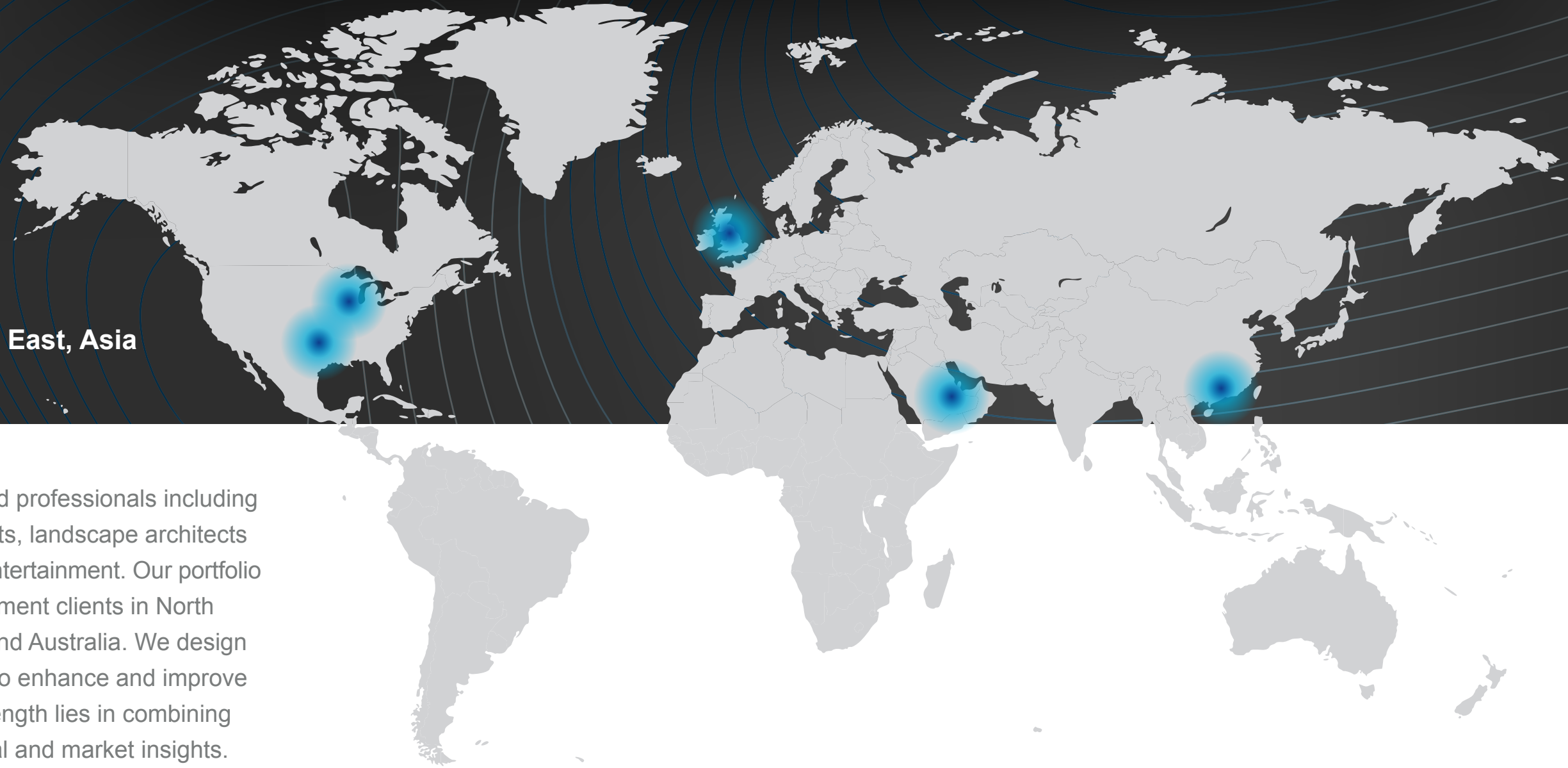

Our global firm has market-specialized professionals including architects, engineers, designers, artists, landscape architects and planners, all dedicated to water entertainment. Our portfolio of work includes leisure and entertainment clients in North America, Europe, Middle East, Asia and Australia. We design and adhere to the highest standards to enhance and improve process in emerging regions. Our strength lies in combining global best practices with local cultural and market insights.

NORTH AMERICA



EUROPE



MIDDLE EAST - AFRICA



ASIA - AUSTRALIA



MELCO RESORTS & ENTERTAINMENT



SERVICES

We transform ideas into unique water experiences, luxury amenities, and holistic water-based connections. Neuman Group collaborates closely with clients, offering our expertise to bring their vision to life through our individualized and water-centric design process. Within our Design | Build process, we carry a deep understanding of cost implications, scheduling and construction management that will realize your project.

- DESIGN SERVICES
- ENGINEERING SERVICES
- CONSTRUCTION SERVICES

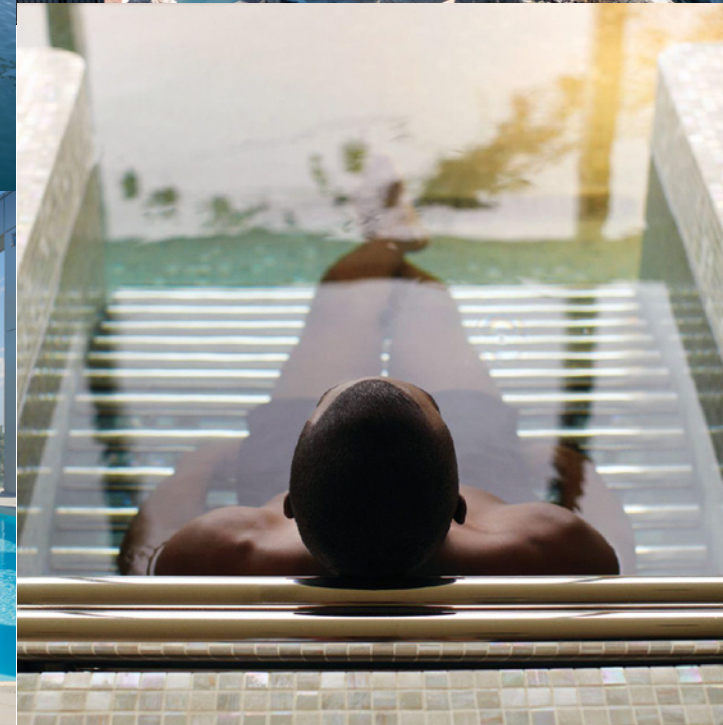

DESIGN SERVICES

Through purposeful planning and intentional design, we shape aquatic environments that are welcoming, intuitive, and inspiring. Thoughtful planning allows us to align vision with feasibility, balancing creativity with practicality and long-term operational success. Our designs are not driven by trends alone, but by how spaces will be used, experienced, and maintained over time. We believe great design is as much about function and flow as it is about aesthetics, ensuring facilities are flexible, inclusive, and built to perform.



MASTER PLANNING



CREATIVE DEVELOPMENT & CONCEPTUAL DESIGN



THEMED AQUATIC ENVIRONMENTS



WATER ATTRACTION INTEGRATION



DETAILED DESIGN

ENGINEERING SERVICES

Through engineering expertise, we bring rigor, precision, and accountability to every detail. Our technical approach prioritizes safety, efficiency, sustainability, and reliability, recognizing that behind every memorable aquatic experience is a system that must work seamlessly, day after day. We measure success not only by what we create, but by how it performs. Collaboration, integrity, and long-term thinking guide our work, as we strive to be trusted partners throughout the full life cycle of each project.

 STRUCTURAL AQUATIC ENGINEERING

 ELECTRICAL AQUATIC ENGINEERING

 WATER FLOW & CFD ANALYSIS

 CONSTRUCTION DOCUMENTATION & SPECIFICATIONS

 ADVANCED WATER TREATMENT RESEARCH



CONSTRUCTION SERVICES

Through disciplined execution and integrated delivery, we bring aquatic environments to life with precision and accountability. Our construction services focus on predictability, quality, and coordination, aligning planning, procurement, and construction to manage complexity and reduce risk. From early cost control and scheduling through installation, startup, and commissioning, our teams emphasize transparency, craftsmanship, and performance. By remaining engaged through opening and beyond, we ensure each facility is delivered ready to operate, maintain, and succeed – day one and long term.

 PRE-CONSTRUCTION SERVICES

 CONSTRUCTION MANAGEMENT

 SCHEDULING & LOGISTICS

 AQUATIC & MECHANICAL INSTALLATION

 START UP & COMMISSIONING

 COST CONTROL PROCUREMENT



PORTFOLIO



The Springs Resort & Spa, located in Pagosa Springs, Colorado, is a renowned hot springs destination that seamlessly blends natural wellness with refined mountain luxury. The resort features an extensive collection of over 25 mineral-rich soaking pools, ranging in temperature and ambiance, all fed by the world's deepest geothermal hot spring. Guests can enjoy sweeping views of the San Juan River and surrounding Rocky Mountains, with therapeutic aquatic amenities and serene relaxation areas designed to promote restoration, balance, and connection to nature.

KEY ROLES INCLUDED:

- Designed and engineered the aquatic systems for the state of the art wellness focused spa experience ensuring seamless integration with geothermal water sources.
- Oversaw the development of key amenities, including the infinity pool, cold plunge pools, and steam rooms.

LOCATION

Pagosa Springs, Co

OWNER

Olympus Real Estate Group | www.pagosahotspings.com

PROJECT HIGHLIGHTS

50+ Geothermal Hot Spring Mineral Pools



PORTFOLIO



Sundara Inn & Spa

Sundara Inn and Spa, nestled in the scenic Wisconsin Dells, is a luxurious retreat renowned for its serene ambiance and holistic approach to wellness. With upscale accommodations, rejuvenating spa treatments, and tranquil spaces like infinity pools, meditation gardens, and a full-service spa, Sundara offers the perfect escape for balance and renewal.

Neuman Group provided the total project management delivery for the year-round indoor/outdoor swim-up bar pool, signature outdoor leisure pool, hot soak whirlpool, and waterfall features.

KEY ROLES INCLUDED:

- Overseeing the design and implementation of the heated infinity pool.
- Ensuring precise engineering for hydrotherapy elements.
- Managing project time lines and coordination to deliver high-quality results.

LOCATION

Wisconsin Dells, Wisconsin

OWNER

Sundara Spa
www.sundaraspa.com

PROJECT HIGHLIGHTS

978 SF Indoor/Outdoor Pool
1380 SF Outdoor Saltwater Leisure Pool
245 SF Indoor Hot Soak Whirlpool with Seating Ledges and Waterfall Feature;
Cambrian Oasis Indoor Space with Conversation Coves



PORTFOLIO



SKY LAGOON

BY PURSU, T™

Sky Lagoon, located in Reykjavik, Iceland, is a stunning geothermal spa that blends modern luxury with traditional Icelandic bathing culture. The lagoon features a range of unique aquatic amenities, including a 250-meter-long infinity pool with panoramic views of the Atlantic Ocean, a cold plunge pool, steam rooms, and saunas, all utilizing the natural geothermal waters of Iceland.

KEY ROLES INCLUDED:

- Designed and engineered the aquatic systems for the lagoon, ensuring seamless integration with geothermal water sources.
- Managed project coordination and timelines to deliver high-quality, sustainable water features.
- Oversaw the development of key amenities, including the infinity pool, cold plunge pools, and steam rooms.
- Ensured the optimal flow and water quality for a luxurious, sustainable spa experience.

LOCATION

Kópavogur, Iceland

OWNER

Sky Lagoon | www.skylagoon.com

PROJECT HIGHLIGHTS

1,555 SM Geothermal Lagoon with a 230 ft infinity edge.



PORTFOLIO



JW MARRIOTT
HOTELS & RESORTS

JW Marriott Resort & Spa, located in the heart of Texas Hill Country, is a refined destination offering elevated luxury amid a serene natural landscape. With championship golf, a full-service spa, and a vibrant mix of pools, a lazy river, and interactive water features, the resort delivers a seamless blend of relaxation, recreation, and Texas hospitality.

KEY ROLES INCLUDED:

- Provided design and engineering for the resort’s pools, lazy river, and play areas.
- Ensured seamless coordination from concept to construction.
- Delivered high-performing aquatic systems that enhance the guest experience.

LOCATION

Wisconsin Dells, Wisconsin

OWNER

Sundara Spa
www.sundaraspa.com

PROJECT HIGHLIGHTS

- | | | |
|--|--------------------------|------------------------|
| 12,980 SF Activity Pool | 2,270 SF Adult Pool | Water Dome |
| Water Spouts | 1,939 SF Children’s Pool | Kiddie Pro Racer Slide |
| 1.150 LF Lazy River with 330 LF Active Channel | 6 Geysers | Kiddie Twister Slide |
| 225 LF Pedernales River Slide | Wall Sprays | 154 SF Adult Spa |
| 275 LF Acequia Tube Slide | Water Wheel | 2,698 SF Spa Pool |
| 1,254 SF Plunge Pool | Kiddie Slide | 247 SF Spa Whirlpool |
| | Catfish Play Feature | |



PORTFOLIO

The Joseph, a Luxury Collection Hotel offers a contemporary luxury experience with a serene 876 SF rooftop leisure pool on the 21st floor. The modern rooftop pool complements the hotel's art-forward aesthetic while providing guests with sweeping city views, a relaxing escape from Broadway, and access to a skyline lounge. Engineered to meet the unique challenges of rooftop aquatic design, the pool system ensures long-term durability and minimal maintenance, delivering a refined amenity that embodies the hotel's sophisticated take on Nashville hospitality.

KEY ROLES INCLUDED:

- Ensuring the aquatic systems align with the architectural vision while meeting technical and operational standards.
- Coordinated project to integrate the pool seamlessly within budget and timelines.
- Delivered top-quality construction support, meeting high standards for aesthetics, functionality, and sustainability.

LOCATION

Nashville, TN

OWNER

Marriott International Inc. | www.the-luxury-collection.marriott.com

PROJECT HIGHLIGHTS

876 SF luxury rooftop pool



PORTFOLIO



The Estates at Acqualina offers a first-of-its-kind living experience. Blending classic opulence with the relaxed elegance of Miami's vibrant lifestyle, residents enjoy in-unit whirlpools, elevated whirlpool spas, and, crowning it all, two cantilevered penthouse pools, perched 47 stories above the city. These extraordinary pools feature glass-bottom floors and see-through side panels, creating a breathtaking ambiance for those swimming or relaxing high above the skyline.

KEY ROLES INCLUDED:

- Ensuring the aquatic systems align with the architectural vision while meeting technical and operational standards.
- Coordinated project to integrate the pool seamlessly within budget and timelines.
- Delivered top-quality construction support, meeting high standards for aesthetics, functionality, and sustainability.

LOCATION

Sunny Isles Beach, FL

OWNER

The Estates at Acqualina | www.estatesatacqualina.com

PROJECT HIGHLIGHTS

In-Unit Elevated Whirlpools
Two-Cantilevered, Glass Bottom Penthouse Pool



PORTFOLIO



The Grand Hotel Resort, perched majestically on Mackinac Island, Michigan, is an iconic retreat celebrated for its historic charm and unparalleled hospitality. Blending classic Victorian elegance with contemporary comforts, the resort provides a captivating escape that invites guests to savor serene lake views and timeless traditions in a uniquely enchanting setting.

KEY ROLES INCLUDED:

- Provided expert design and construction services for the historic pool renovation, blending modern features with classic charm.
- Installed a family-friendly area with zero-depth entry, water jets, and slide.
- Developed an adults-only infinity-edge pool showcasing panoramic views of the Straits and Mackinac Bridge.

LOCATION

Mackinac Island, Michigan

OWNER

KSI Capota; | www.grandhotel.com

PROJECT HIGHLIGHTS

6,166 SF Leisure Pool with Zero-Depth Entry

Water Jet Play Area

Waterslide

220 SF Family Whirlpool

918 SF Adult Whirlpool with Infinity Edge

AWARDS

Aquatics International Dream Designs, 2022

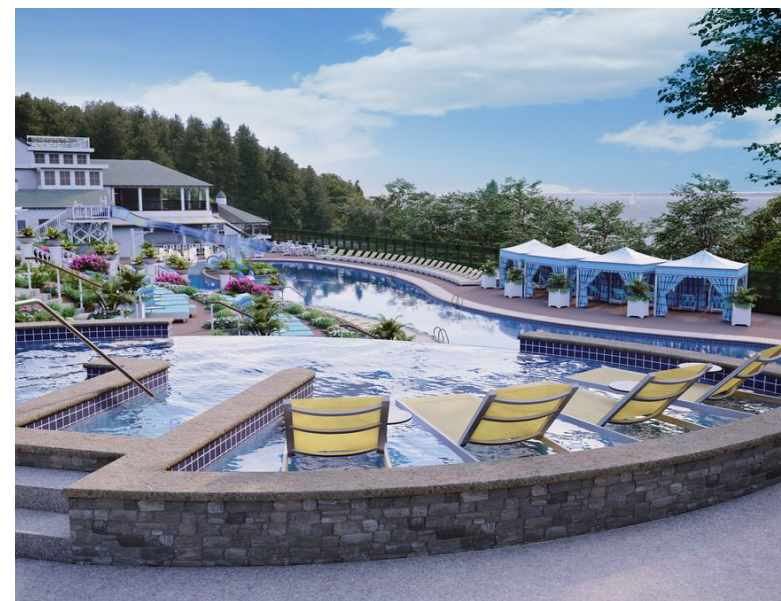



| CONTACT INFORMATION

NORTH AMERICA

Wisconsin

Corporate Office
100 Park Avenue
Beaver Dam, WI 53916

t. 9208877375

Texas

6200 North Beach Street
Suite 100
Haltom City, TX 76137

Regional Locations

- California
- Florida
- South Carolina
- Washington

EUROPE

United Kingdom

8 & 9 Jayes Park Courtyard
Ockley, Surrey
RH5 5RR UK

t. 9208877375

MIDDLE EAST

Kingdom of Saudi Arabia

ASIA

Hong Kong